

## Water Hammer Eliminator : Model HA / HA UNIT

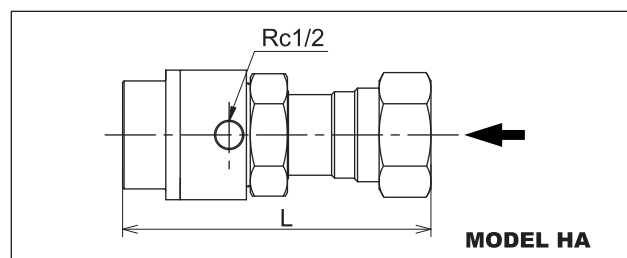
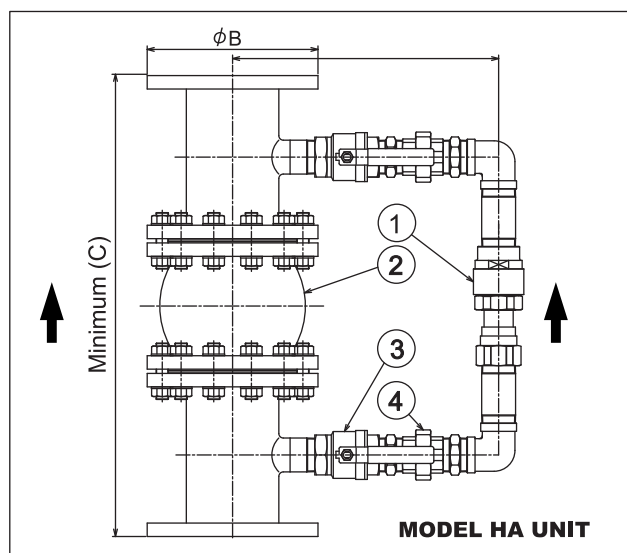

### Materials:

No.	Description	material
1	Water Hammer Eliminator (SIZE: 3/4" & 2")	Bronze
2	Check Valve	Ductile iron
3	Ball Valve	Bronze
4	Slip on Flanges	Stainless Steel

### Dimensions: MODEL HA UNIT

unit : mm

Connection Standard : JIS B 2240				
Nom. Size		A	B	C
mm	inch			
100	4	(377)	φ 225	(670)
150	6	(404)	φ 305	(670)
Flange		JIS 10K		

unit : mm

Connection Standard : ISO 7005-3 (BS 4504)				
Nom. Size		A	B	C
mm	inch			
100	4	(377)	φ 220	(670)
150	6	(404)	φ 285	(670)
Flange		PN16		

### : MODEL HA

unit : mm

Connection Standard : JIS B 0203 & BS21				
Nom. Size		L	Conection	
mm	inch			
20	3/4	(181)	Rc 3/4	
50	2	(214)	Rc 2	

### Water hammer characteristics:

Test conditions : 1. Velocity in pipe 2 m/sec 2. Vertical pipe length 20m (nominal size 2" , flow rate 236 L/min )

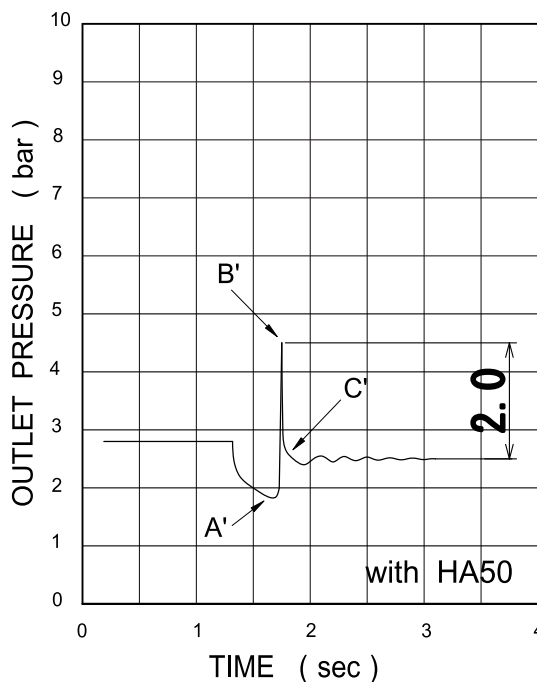
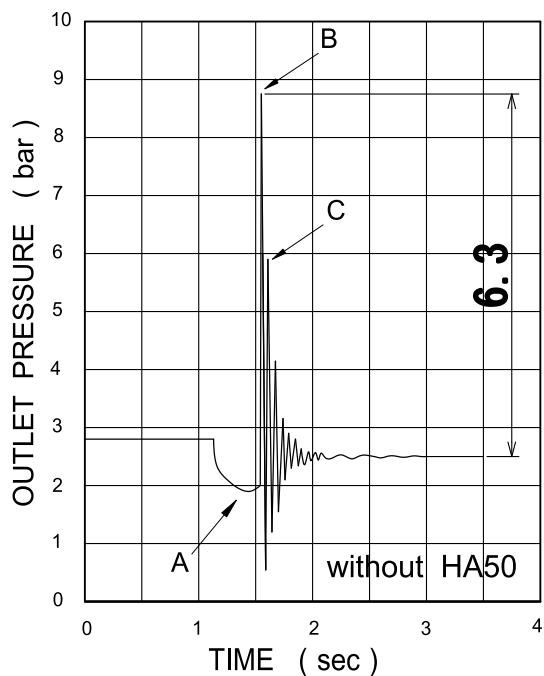

### ISO9001 Certified

Japanese Industrial Standard Permitted Factory  
Japan Water Works Association Authorized Factory

## KKK KANE KOGYO Co., Ltd.

Head office and factory : 2036 Okusa, Komaki-shi, Aichi-ken 485-0802 Japan

TEL : 81-568-79-2476 FAX : 81-568-79-6422

Web site: <http://www.kkk-kane.co.jp> E-mail: [overseasales@kkk-kane.co.jp](mailto:overseasales@kkk-kane.co.jp)

Edition 1-2/2004

# Model HA INSTALLATION PIPING DIAGRAM

Basically two HA unit should be installed after transfer pump and after elbow.

In this case, pump and riser pipe is very close so it was not necessary.

If the distance between pump and riser is longer than 20m or more and if there is more than 3 pieces of elbow are installed at pipes then two HA UNIT should be installed.

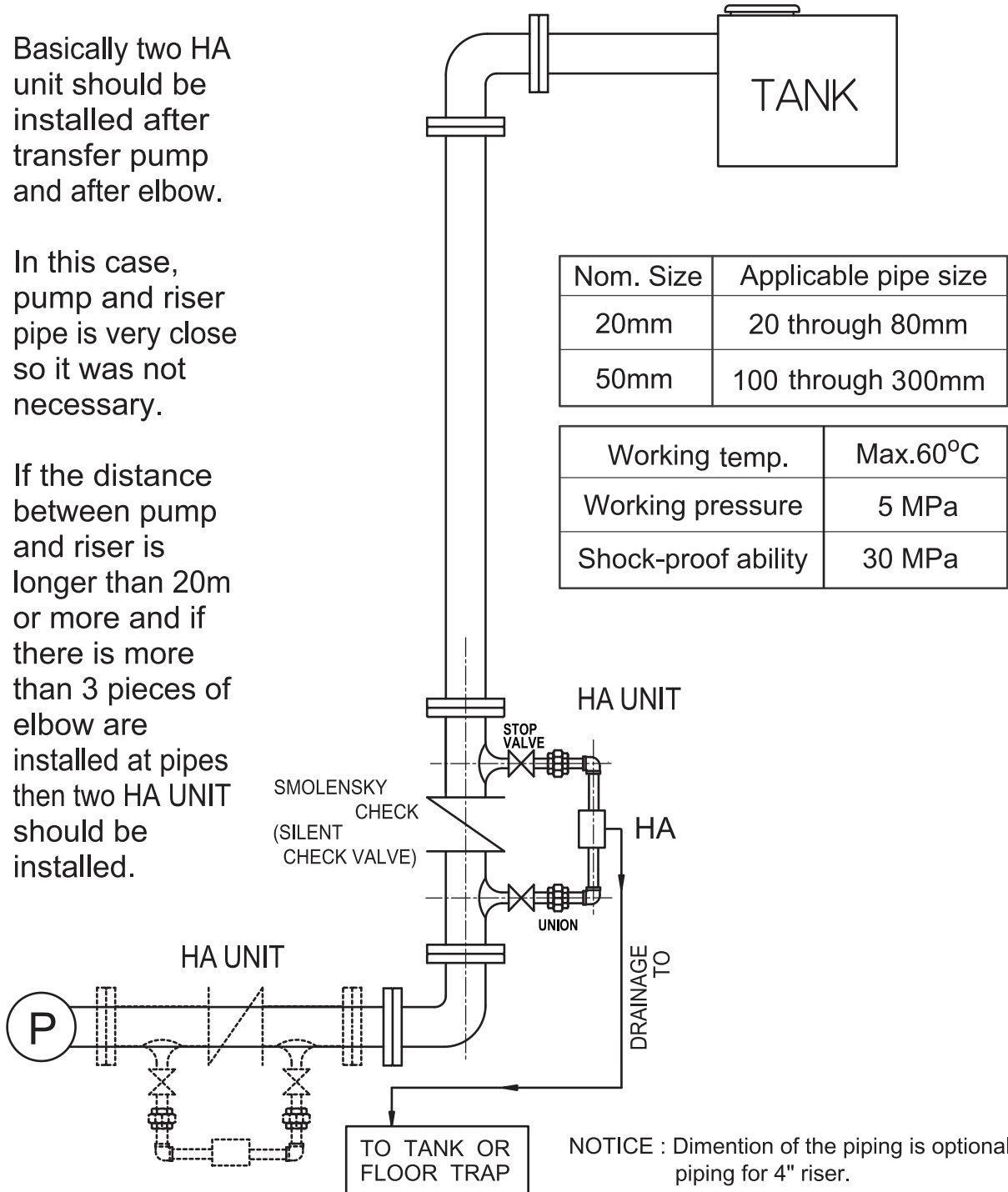

NOTICE : Dimention of the piping is optional piping for 4" riser.